

INSTALLATION INSTRUCTIONS

Electronic Basin Faucet 感應式龍頭(冷)

※ Mounting the Plastic Control Box without Screw, please follow the Installation of Plastic Control Box.
若不使用螺絲固定電磁閥控制盒，請見電磁閥控制盒說明書

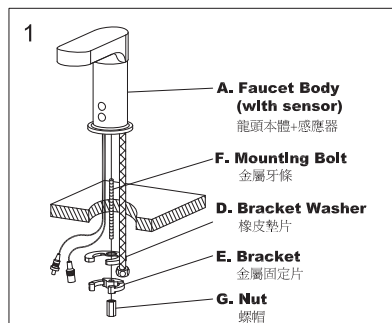

Screw **Mounting Bolt** into **Faucet Body**. Insert **Flexible Hoses, Mounting Bolt and wires** through basin hole in fixture. Place **Bracket (with Bracket Washer)** and **Nut** onto **Mounting Bolt**, position faucet on fixture, then tighten **Nut** securely.

將金屬牙條鎖入龍頭本體，連同編織管及電線穿過檯面洞口。從金屬牙條下方依圖示套入橡皮墊片、金屬固定片和螺帽，確認龍頭方向後，鎖緊螺帽。

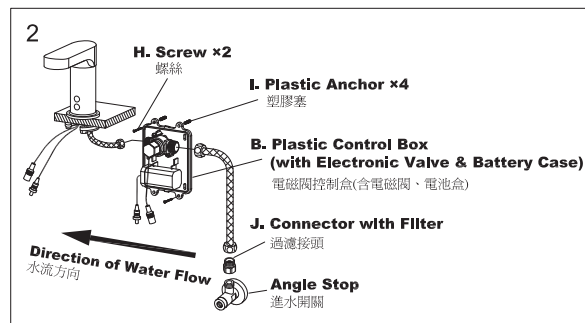

Take off the cover of **Plastic Control Box**, connect the **Flexible Hoses to Faucet, Electronic Valve and Connector with Filter**. Select proper position for **Plastic Control Box** and mark center of mounting holes on wall. Using a 6mm drill-bit, drill the holes in marked positions to a depth of 4cm. Insert four **Plastic Anchors** and install the **Plastic Control Box** on the wall with two screws as fig.2 shown.

取下電磁閥控制盒的上蓋，將編織管、電磁閥、過濾接頭結合(圖2)。選擇欲安裝電磁閥控制盒的位置並畫上鑽孔記號，使用6mm鑽頭鑽孔(深度4cm)。安裝四顆塑膠塞後，先以二顆螺絲將電磁閥控制盒固定於牆面。

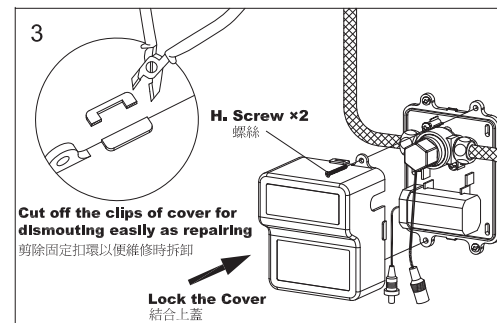

Cut off the clips of cover for dismounting easily as repairing. After install the batteries, lock the cover with the rest of two screws and open the Angle Stop. **(Note: Please DO NOT cut the clips of cover if you need it to fix the cover.)**

將上蓋的固定扣環剪除以便維修時拆卸。安裝電池後，用另二顆螺絲結合上蓋，並打開進水開關。(注意：若不以螺絲固定電磁閥控制盒，請不要剪除上蓋的固定扣環)

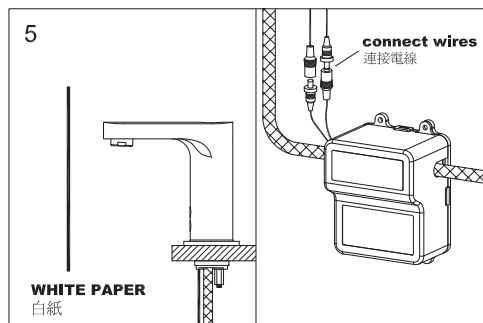

The sensor would adjust the distance of reaction automatically after the wires has been connected. If you need reset distance of reaction, please place a white paper in front of the sensor at the proper position before connect the wires. (The farthest distance is 40 cm)

連接電線後，感應器將依現場環境自動調整感應距離。若須自訂感應距離，請在連接電線之前，以白紙固定於感應器前方再接上電源(最遠可調整至40公分)

FIXING CONTENTS

組配件內容

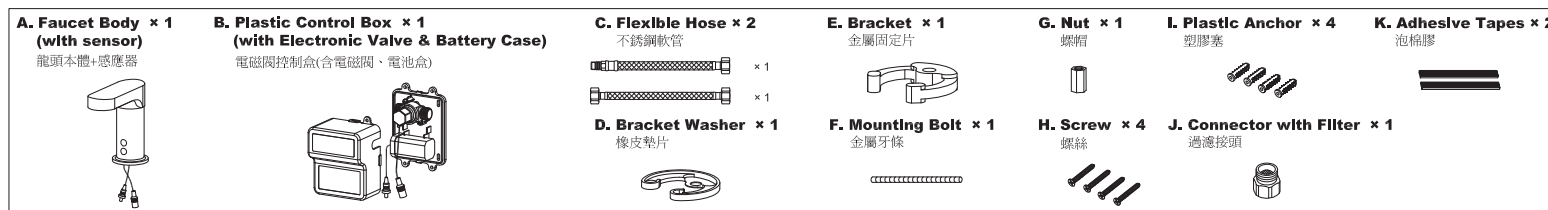

Specification Sheet 規格表

- Power Source: Alkaline Battery AA x 4, DC6V(1.5V x 4)
電源建議：DC1.5V AA x 4 (6V)鹼性電池
- Power up Procedure: Power Up→Turn Valve Off→LED Blink twice→Turn Valve On→Setting Water Flow Parameters, LED Blink Twice at the same time→Turn Valve off→Setting Non Water Flow Parameters, LED Blink Twice at the same time→LED Blink Twice again→Normal Routine Operation
開機程序：通電→關閉→LED閃兩次→開閥→LED閃兩次，偵測水流環境參數→關閉→LED閃兩次，偵測沒水環境參數→LED閃兩次→正常工作
- Power up Safety Guard: Valve Off after Power up
每次新裝電池，開機指示燈確認後，立即送出關水信號一次確保電磁閥為關水狀態
- The faucet can stand the pressure from 0.3 to 10 kg/cm2
適用水壓0.3~10 KG/CM2
- Aerator with pivot joint can be tilted for 7 degrees
起泡頭可調整角度為前後7度
- Safety Guard: Valve off if water flowing over 45sec
自保模式：連續給水45秒後自動閉閥
- Sensing Range: Range Auto Adjustment within 40cm (by A4 white)
感應距離：自動調距最遠40cm(A4 白紙)
- The sensor might not be operated normally as the water pressure has been increased over 2 kg/cm2. Please plug out the power and plug in again after 5 seconds for the sensor retesting the water flow, and then sensor will be operated regularly.
環境偵測：若水壓超過安裝時的水壓達2公斤以上，可能因水花顏色導致感應器無法正常工作，此時請將電源拔掉約5秒再接上，讓感應器重新偵測水花後即可正常運作

Trouble Shooting 故障排除

- If the **Flush Valve** doesn't work :
若有未出水的情況，請檢查：
whether there is water comes from the pipe.
→please check the water supply system
管路是否有水→檢查供水系統
whether the power of battery is enough.
→please replace battery
電力是否足夠→更換電池
Whether the power is connected
→please plug in
電源是否連接→接上電線
- If the flow rate gets lower :
若水流量變少
Whether there are obstructions of Connector with Filter
→please clean the Filter
檢查過濾接頭是否堵塞→清潔濾網